

ABM7020 Roller Nut (ST-Style)

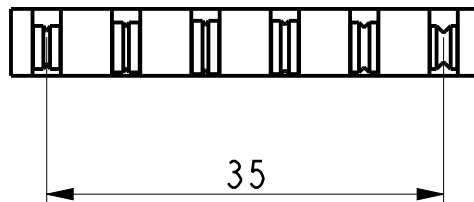
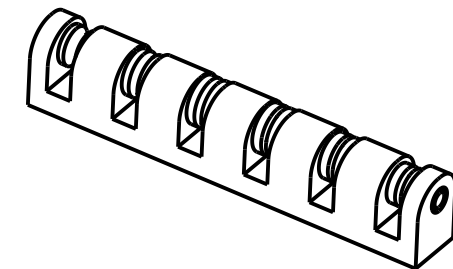
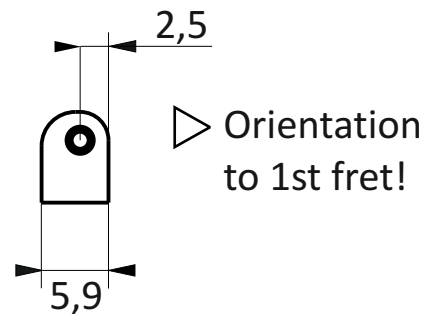
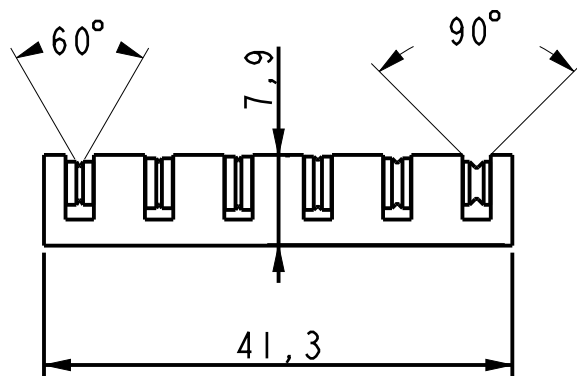

All length dimensions are given in mm

Description

- Milled from solid Bell Brass
- for ST-Guitars with 9.5" fretboard
- variable roller shape for a perfect emulation emulation and guiding
- fills the widened gap that has to be made in order to place the rollers in the middle of the point support of the former non-roller saddle